



Philadelphia Hardware Group, Inc.

6590 Top Gun St.
San Diego, CA 92121
www.philhardware.com
Tel: 858-642-0450
Fax: 858-642-0454



ES Series Electric Strike: ES-86

ES-86 for use with mortise type single point lock or latches having a 3/4 in. latch bolt on fire doors and frames with ratings up to and including 1 hour.

FEATURES

- ES-86 fits frame template 4-7/8" for ASA strike.
- Keeper strength: 1500Lbs.
- Field selectable fail-safe / fail-secure.
- Accommodates 3/4" latch throw.
- Use with mortise locksets without deadbolt.
- Dual Voltage 12/24 VDC.
- Non-handed.



ES-86

SPECIFICATIONS

- Operating Voltage: 12/24VDC
- Current Draw: 0.25A/12VDC; 0.15A/24VDC (at temperature 20°C)
- Operating Temperature: 14°F~113°F (-10°F~+45°C)
- Humidity: 0~95% non-condensing.
- Durability: 1,000,000 cycles(solenoid)
- Function: Field selectable fail-safe / fail-secure.
- Keeper width: 1-13/32" (36 mm) for accommodating 1" width latch bolt.
- Material: zinc alloy main stand, stainless steel faceplate

DIMENSIONS

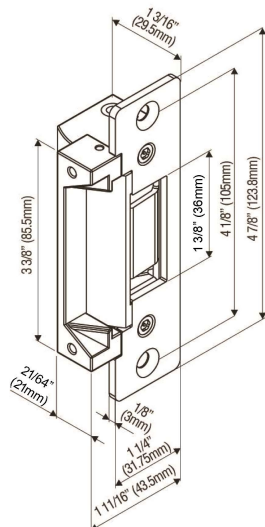

ACCESSORIES

Extension bracket for wider jamb

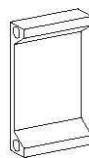

EB-01
2" wide

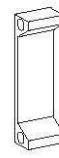

EB-02
1" wide

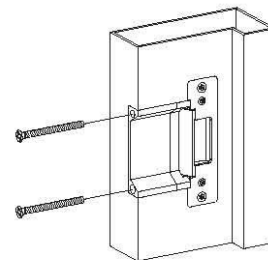

SAN DIEGO

CHICAGO

ATLANTA

DALLAS