



6590 Top Gun Street
San Diego, CA 92121
www.philhardware.com

Philadelphia Hardware Group Inc.

Tel
858.642.0450
858.545.2309
Fax
858.642.0454

AGH-053HD Half Surface Gear Hinge

- Half Surface application.
Frame leaf alignment rib for proper hinge location
- Heavy duty for high frequency doors or heavy, medium frequency doors.
- Security channel covers.
- 1/8" (3 mm) inset

SPECIFICATIONS

CLEARANCE:
5/32" (4 mm) minimum recommended hinge side plus standard lock side clearance.

- FASTENERS:**
- 1/4-20 x 1-1/4" Sexbolt (Screw + Post).
 - #12-24 X 11/16" Flat Head Self-Drill Screws.

LENGTH OPTIONS:
Standard 83" and 95", custom size available.

MATERIAL: Aluminum 6063-T6



AGH-053HD Gear Hinge

Available Items

ITEM	LENGTH (CM)	FINISH
AGH-053HD-83	83" (210.8)	Clear Anodized
AGH-053HD-83	83" (210.8)	Dark Bronze
AGH-053HD-95	95" (241.3)	Clear Anodized
AGH-053HD-95	95" (241.3)	Dark Bronze

* Special order for other size and finish.

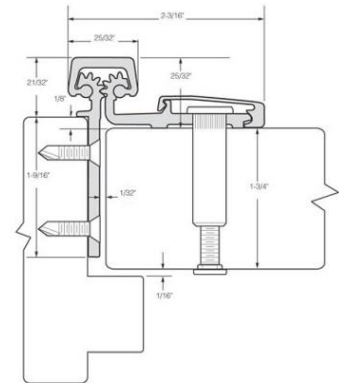

Application Example

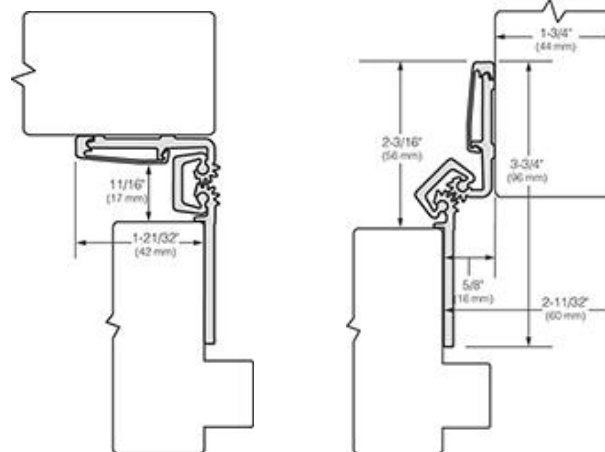

SAN DIEGO

CHICAGO

ATLANTA

DALLAS



Philadelphia Hardware Group Inc.

Tel
 858.642.0450
 858.545.2309
 Fax
 858.642.0454

APPLICATION TEMPLATE

Example for 83"

