



Philadelphia Hardware Group, Inc.

6590 Top Gun Street
San Diego, CA 92121
www.philihardware.com
Tel
858.642.0450
858.545.2309
Fax
858.642.0454

Commercial Hinge

Plain Bearing

SPECIFICATIONS

- 5 Knuckles, non-rising removable pin with button tip and plug.
- Corner options: Square, 1/2" radius corner, or 5/8" radius corners.
- Full Mortise, timely template (ANSI A156.7).
- Finish – various finishes available, please refer to price book for details.

MATERIAL: Steel with Steel Pin

- Steel ANSI A8133

CODE	SIZE	RADIUS	MATERIAL	Gauge
CH320	3-1/2" x 3-1/2"	1/4"	steel	0.12" (3.1mm)
CH350	3-1/2" x 3-1/2"	square	steel	0.12" (3.1mm)
CH400	4" x 4"	square	steel	0.13" (3.3mm)
CH402	4" x 4"	1/4"	steel	0.13" (3.3mm)
CH405	4" x 4"	5/8"	steel	0.13" (3.3mm)
CH450	4-1/2" x 4-1/2"	square	steel	0.134" (3.4mm)

N.R.P. ITEMS

- Steel ANSI A8133

CODE	SIZE	RADIUS	MATERIAL	Gauge
CN350	3-1/2" x 3-1/2"	square	steel	0.12" (3.1mm)
CN400	4" x 4"	square	steel	0.13" (3.3mm)
CN402	4" x 4"	1/4" radius	steel	0.13" (3.3mm)
CN405	4" x 4"	5/8" radius	steel	0.13" (3.3mm)
CN450	4-1/2" x 4-1/2"	square	steel	0.134" (3.4mm)

MATERIAL: Brass with Brass Pin

- Brass ANSI A2133

CODE	SIZE	RADIUS	MATERIAL	Gauge
193503	3-1/2" x 3-1/2"	square	brass	0.12" (3.1mm)
194003	4" x 4"	square	brass	0.13" (3.3mm)
194203	4-1/2" x 4-1/2"	square	brass	0.13" (3.3mm)

N.R.P. ITEMS

CODE	SIZE	RADIUS	MATERIAL	Gauge
193553	3-1/2" x 3-1/2"	square	brass	0.12" (3.1mm)
194053	4" x 4"	square	brass	0.13" (3.3mm)
194253	4-1/2" x 4-1/2"	square	brass	0.13" (3.3mm)



CH4002
4" x 4" x square US10B



6590 Top Gun Street
San Diego, CA 92121
www.philihardware.com

Philadelphia Hardware Group, Inc.

Tel
858.642.0450
858.545.2309
Fax
858.642.0454

MATERIAL: Stainless Steel with Stainless Steel Pin

- Stainless Steel ANSI A5133

CODE	SIZE	RADIUS	MATERIAL	Gauge
144209	4" x 4"	square	stainless steel	0.13" (3.3mm)
145058	4-1/2" x 4-1/2"	square	stainless steel	0.13" (3.3mm)

N.R.P. ITEMS

CODE	SIZE	RADIUS	MATERIAL	Gauge
144259	4" x 4"	square	stainless steel	0.13" (3.3mm)
145558	4-1/2" x 4-1/2"	square	stainless steel	0.13" (3.3mm)

PACKING

Box for All Plain Bearing Hinges, 3pcs Hinges in one Box. Each Hinge come with poly bag

SCREWS

3-1/2" Hinges (per 3pcs)

1bag (18pcs) of #10 x 1" Wood screws

1bag (9pcs) of #10 x 1/2" 10-24NC Machine screws

4" Hinges (per 3pcs)

1bag (24pcs) of #12 x 1-1/4" Wood screws

1bag (12pcs) of #12 x 1/2" 12-24NC Machine screws

4-1/2" Hinges (per 3pcs)

1bag (24pcs) of #12 x 1-1/4" Wood screws

2bags (12pcs) of #12 x 1/2" 12-24NC Machine screws, totally 24pcs

DIMENSIONS

COMMERCIAL HINGE 4" X 4" (Plain Bearing)

Not To Scale

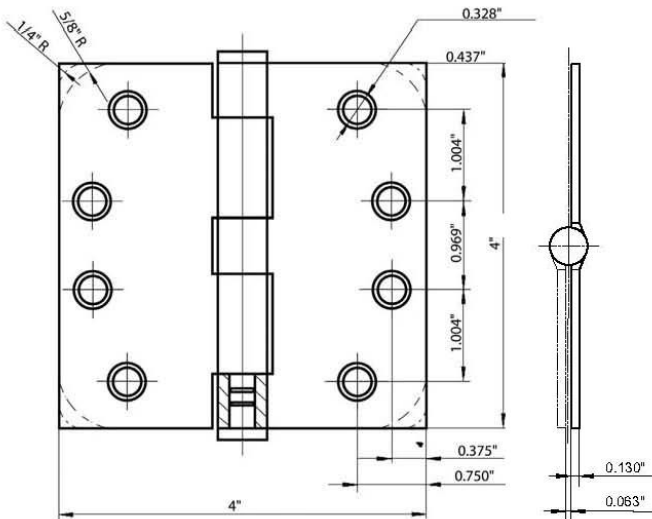

SAN DIEGO

COMMERCIAL HINGE

4 1/2" X 4 1/2"

Not To Scale

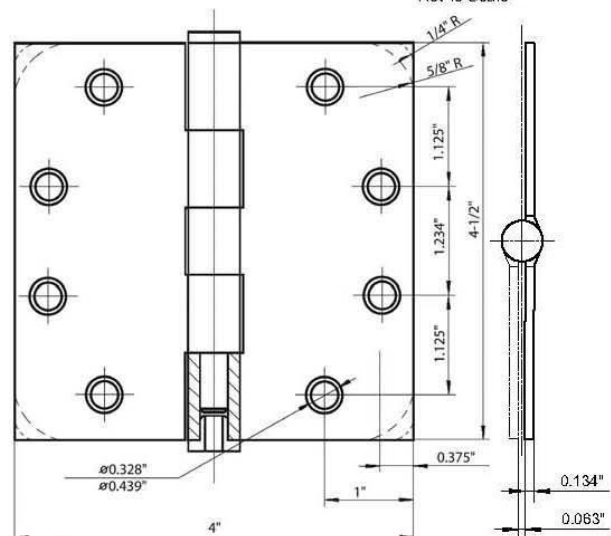

CHICAGO

SEATTLE